



£105,000

19 WESTWOOD GARDENS, SCARBOROUGH, YO1 2JQ

- Ground Floor Apartment
- One Double Bedroom
- Well Presented
- Private Gardens

A SUPERB ONE BEDROOM GROUND FLOOR APARTMENT IN THIS CONVENIENT LOCATION CLOSE TO ALL OF THE TOWN CENTRE'S AMENITIES. WELL LAID OUT WITH BAY FRONTED LIVING ROOM, LARGE DOUBLE BEDROOM, WELL PRESENTED KITCHEN AND BATHROOM ALSO PRIVATE ESTABLISHED GARDENS TO THREE SIDES.



TIPPLE UNDERWOOD ESTATE AGENTS

3 Coldyhill Lane, Scarborough, North Yorkshire, YO12 6SF

CONTACT

www.tippleunderwood.co.uk

01723 350299

mail@tippleunderwood.co.uk

Agents Note: Whilst every care has been taken to prepare these sales particulars, they are for guidance purposes only. All measurements are approximate and for general guidance purposes only and whilst every care has been taken to ensure their accuracy, they should not be relied upon and potential buyers are advised to recheck the measurements

GROUND FLOOR
527 sq.ft. (49.0 sq.m.) approx.

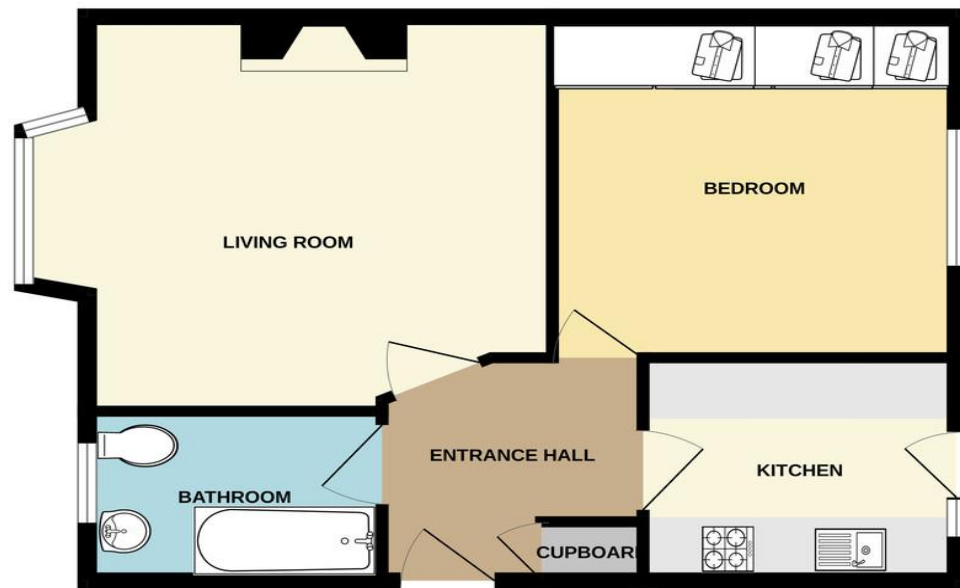

TOTAL FLOOR AREA: 527 sq.ft. (49.0 sq.m.) approx.
Whilst every attempt has been made to ensure the accuracy of the floorplan contained here, measurements of doors, windows, rooms and any other items are approximate and no responsibility is taken for any error, omission or mis-statement. This plan is for illustrative purposes only and should be used as such by any prospective purchaser. The services, systems and appliances shown have not been tested and no guarantee as to their operability or efficiency can be given.
Made with Metropix ©2024



Property Description

Tucked away on this pleasant crescent close to the town centre is this bright and airy ground floor apartment and when briefly described comprises entrance hall, bay fronted living room, rear facing double bedroom with fitted furniture. Modern kitchen, white bathroom suite with shower over bath, gas central heating and upvc double glazing. Lovely gardens to the outside, two storerooms and private access gates to Westwood.

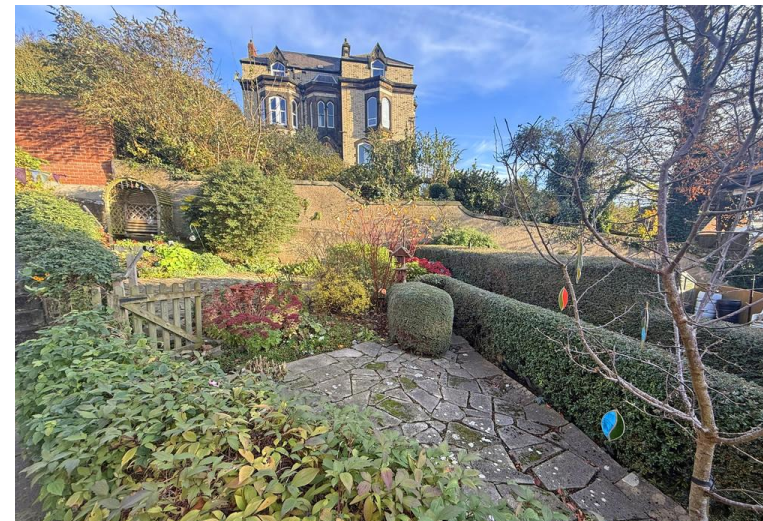

GROUND FLOOR

ENTRANCE HALL

LIVING ROOM
14' 0" x 13' 9" (4.27m x 4.19m) max

KITCHEN
8' 6" x 7' 9" (2.59m x 2.36m)

BEDROOM
12' 3" x 11' 10" (3.73m x 3.61m)

BATHROOM
8' 4" x 6' 2" (2.54m x 1.88m)

OUTSIDE

GARDENS

STORAGE